

# Sechskantmuttern

mit Flansch

# Šest'hranná matica

s límcom

DIN

**6923**

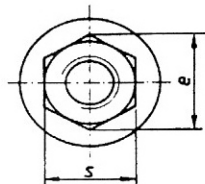
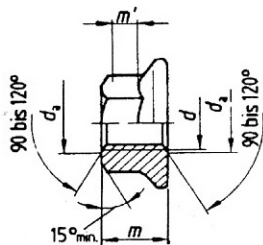

8

FESTIGKEIT  
OBERFLÄCHE

verz.

$d$	$e$	$m$	$s$	$d_c$	
<b>M 5</b>	8,79	5	8	11,8	LG
<b>M 6</b>	11,5	6	10	14,2	LG
<b>M 8</b>	14,38	8	13	17,9	LG
<b>M 10</b>	16,64	10	15	21,8	LG
<b>M 12</b>	20,03	12	18	26	LG