

Nutmutter Matica KM

DIN

981

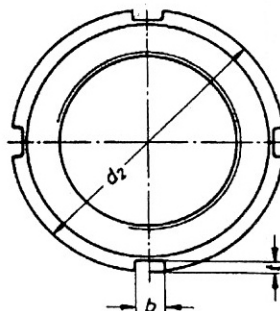
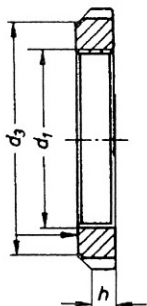

11H
MATERIAL
OBERFLÄCHE
blank

Bezeichnung	d 1	d 2	d 3	h
KM 4	20x1	32	26	6
KM 5	25x1,5	38	32	7
KM 6	30x1,5	45	38	7
KM 7	35x1,5	52	44	8
KM 8	40x1,5	58	50	9
KM 9	45x1,5	65	56	10
KM 10	50x1,5	70	61	11
KM 11	55x2	75	67	11
KM 12	60x2	80	73	11
KM 13	65x2	85	79	12
KM 14	70x2	92	85	12
KM 15	75x2	98	90	13
KM 16	80x2	105	95	15
KM 20	100x2	130	120	18
KM 31	155x3	210	182	25

NA DOPYT